



PLASTIC COIL (RS VARIANT FOR "D15" COIL)



Type of protection (in relation to the connector)	IP 66
Number of cycles	18.000/h
Supply tolerance	±10%
Ambient temperature	-54°C ÷ 60°C
Duty cycle	100% ED
Insulation class wire	H
Weight	0,2 Kg

MOUNTING COMPATIBILITY

CETOP 3	CH. I PAGE 8
AD3.E...	CH. I PAGE 11
ADL.06...	CH. I PAGE 64

VOLTAGE (V)	MAX. WINDING TEMPERATURE (AMBIENT TEMPERATURE 25°C)	RATED POWER (W)	RESISTANCE AT 20°C (OHM) ±10%
12V	110°C	30	4.8
24V	110°C	30	18.8
28V*	110°C	30	25.6
110V(**)(***)	110°C	30	387

* Special voltages

** The european low voltage directive is applied to electrical equipments used at a nominal voltages between 50 and 1000 VAC or 75 and 1500 VDC. In conformity with the low directive each part of the manifold or the subplate on which the valve is mounted should be connected to a protective earth with a resistance less than 0.1 ohms.

SPARE PARTS

D15 PLASTIC COIL (DC / 30W)	
VOLTAGE	HIRSCHMANN (STANDARD)
12V (L)	M14630002
24V (M)	M14630004
28V* (V)	M14630005
110V* (P)	M14630008
(*)SPECIAL VOLTAGES ETD15BR-CODE - 00/2007/e	

CODE SPARE PARTS B / C / D / E / F / G		FOR RS VARIANT
B	O RING (TUBE)	Q25830024
C	RING NUT	M37050030
D	O RING (RING NUT)	Q25830185
E	O RING (COIL)	Q25830028
F	TUBE	M83130001
G	HEX. PUSHROD (MOUNTING C-E-F) (MOUNTING G-H-I) (MOUNTING D)	M74470001 M74470002 M74470003

PLASTIC COIL (RS VARIANT)

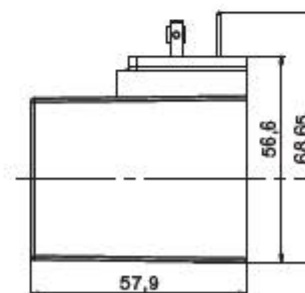

- SEE BELOW FOR EXPLODED VIEW DRAWING
- SEE "D15" COIL STANDARD FOR BOTH EMERGENCY MANUAL ES AND ROTARY P2.