

---

**JMPIAZ - JMPID Electronic remote current control unit**

---





JMPIAZ joystick is a strong and compact device, whose ergonomic shape is handily organised.

The person present system switch and many other remote control functions can be implemented and operated conveniently. It is developed to meet mobile machinery market requirements, where it is increasingly important to handle the power transmission supply with integrated remote control.

JMPIAZ is simple to fit and replace and is made up of a standard module with two proportional axes and a hand grip that can house several combinations of other proportional axes (up to 4) and ON/OFF outputs.

This joystick allows all the electronic features of ramp generator function, electronic flow adjustment, and dead band compensation (only for proportional axes).

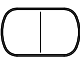
## ORDERING CODE

		<b>JMPIAZM70</b>		<b>X</b>	<b>Y</b>	<b>Z</b>	<b>W</b>
Supply voltage	<div>0 12V</div> <div>2 24V</div>						
	ON/OFF push buttons <div> <div>0</div><div>1</div><div>2</div><div>3</div><div>4</div><div>5</div><div>6</div> </div> No. of switches in the hand grip side						
	Z axis position <div> <div>0 none</div> <div>H horizontal</div> <div>L left</div> <div>R right</div> <div>B both (L+R)</div> </div>						
	Additional ON/OFF push buttons <div> <div>0 none</div> <div>T Top</div> <div>D person present system</div> <div>B both (T+D)</div> </div>						

ON/OFF push buttons (**Y**)  
and Z axis position (**Z**)

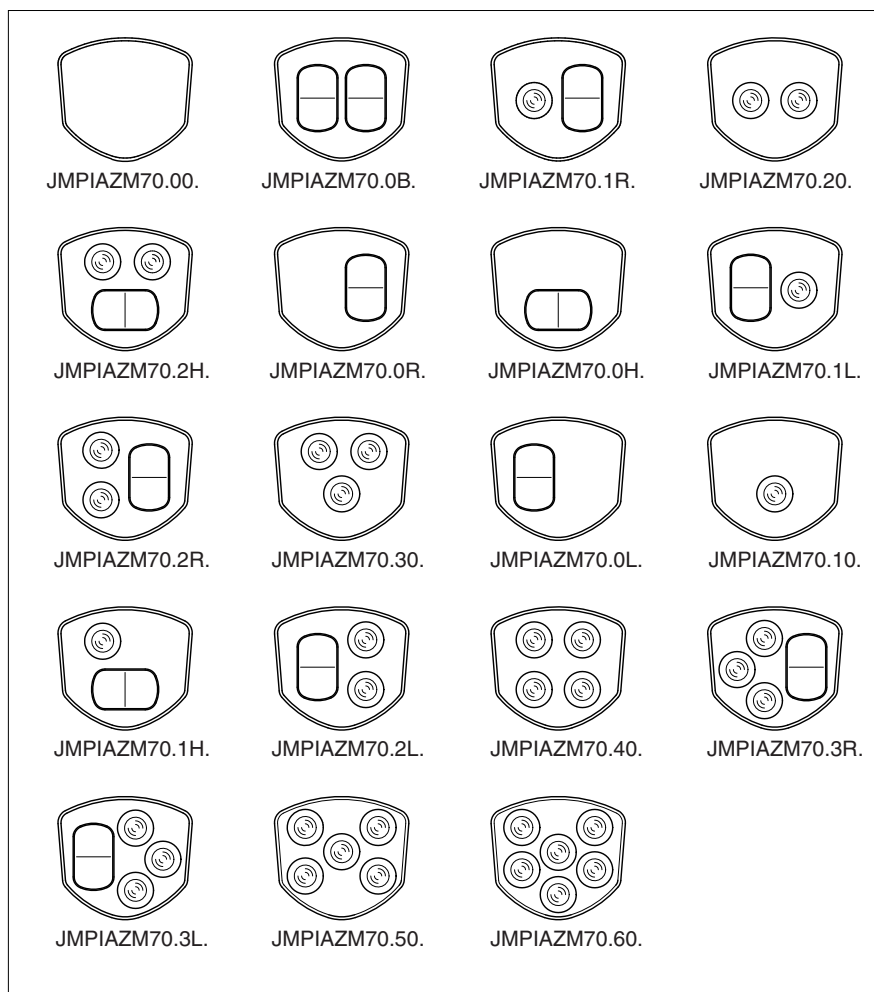

Additional ON/OFF push  
buttons (**W**)

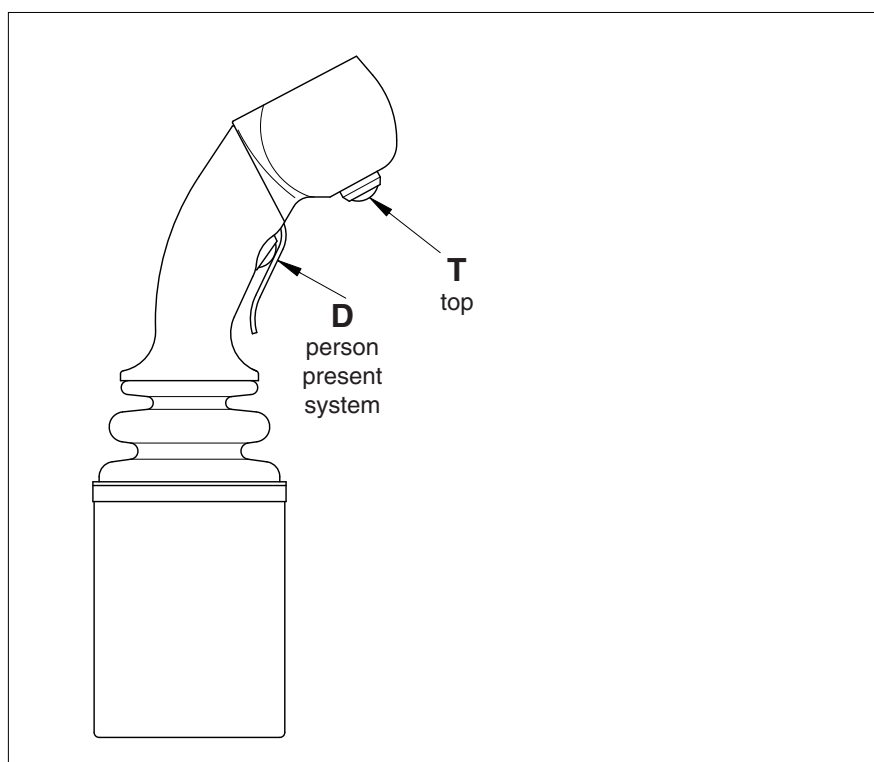

## Dimensions and electrical details

### JMPIAZM70240D

- 4 ON/OFF push buttons in hand grip side
- NO Z axis
- deadman push button

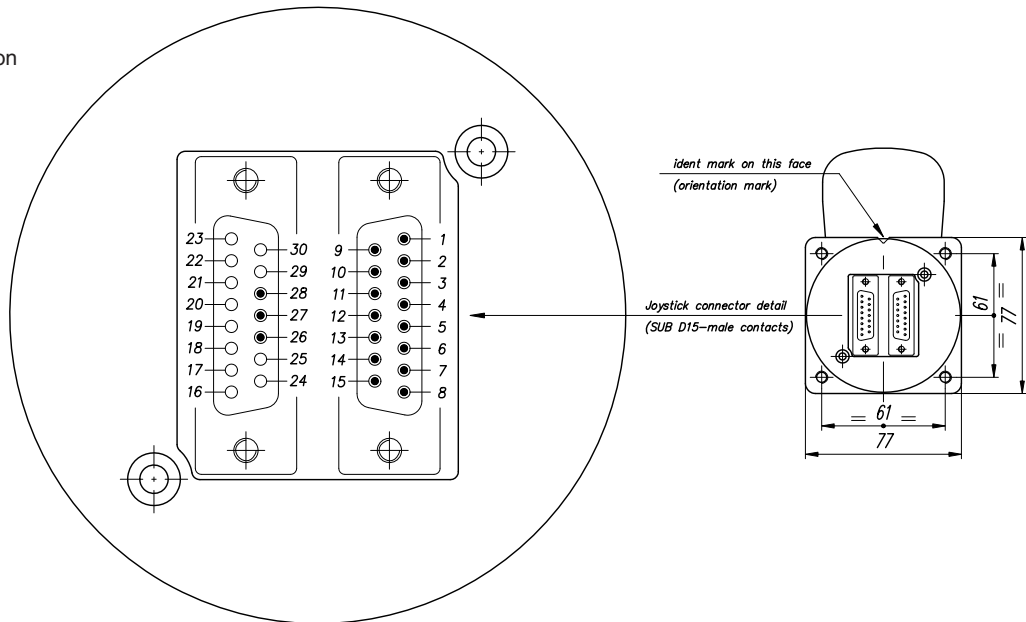

JMPIAZM70040D (12 V)  
JMPIAZM70240D (24 V)

- 1 = U-
- 2 = A / B common X axis
- 3 = A output control, X axis
- 4 = B output control, X axis
- 5 = B output control, Y axis
- 6 = A output control, Y axis
- 7 = A / B common Y axis
- 8 = U+
- 9 = "A" port, directional output (max. load 30 mA)
- 10 = "B" port, directional output (max. load 30 mA)
- 11 = US+ ( Safety output )
- 12 = U S+ ( Safety in )
- 13 = on-off output (max. load 30 mA)
- 14 = "B" port, directional output (max. load 30 mA)
- 15 = "A" port, directional output (max. load 30 mA)
- 16 = ( free )
- 17 = ( free )
- 18 = ( free )
- 19 = ( free )
- 20 = ( free )
- 21 = ( free )
- 22 = ( free )
- 23 = ( free )
- 24 = ( free )
- 25 = ( free )
- 26 = on-off output (max. load 30 mA)
- 27 = on-off output (max. load 30 mA)
- 28 = on-off output (max. load 30 mA)
- 29 = ( free )
- 30 = ( free )

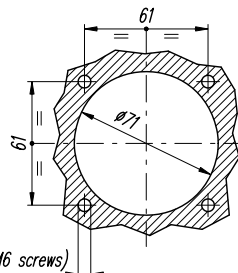
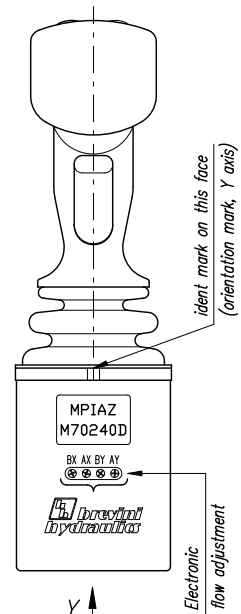
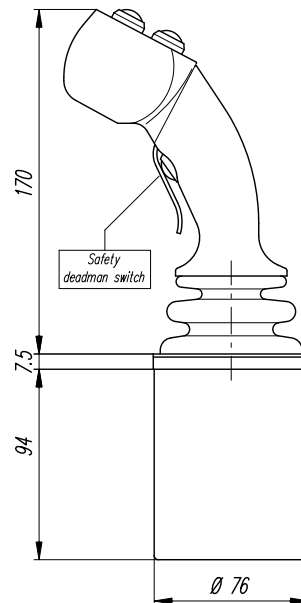
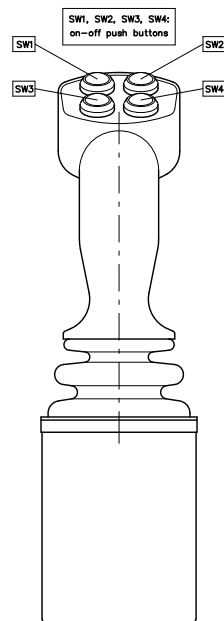

Ø 6.25 (4 holes to fit M6 screws)

PANEL MOUNTING  
DETAILS

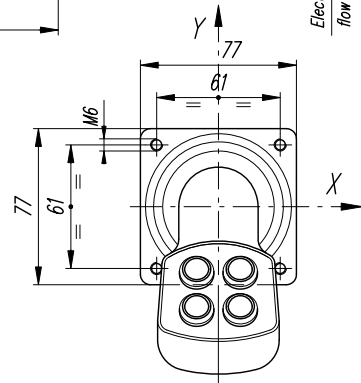

Electrical system

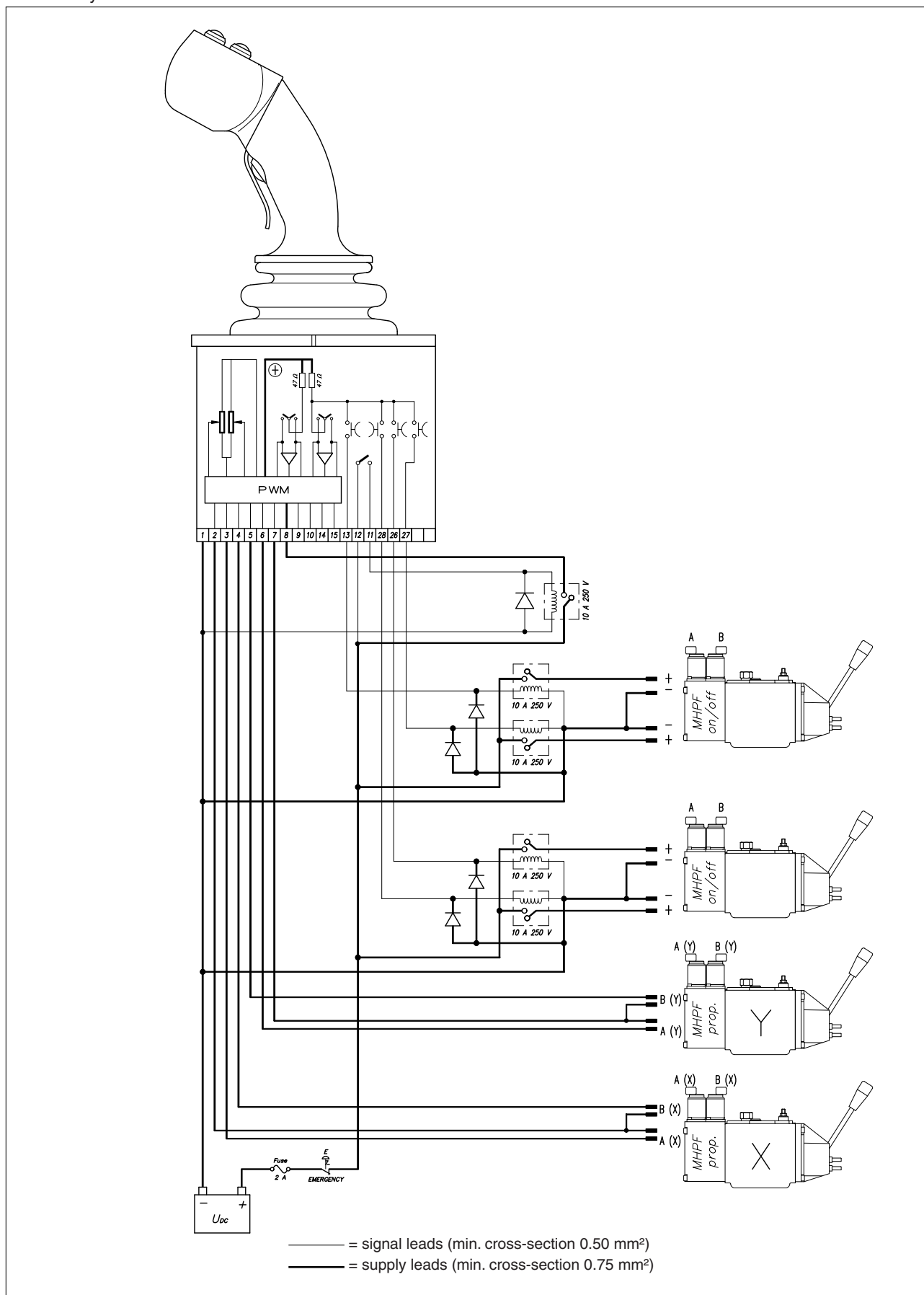

## Dimensions and electrical details

### JMPIAZM7002LD (12V) JMPIAZM7022LD (24V)

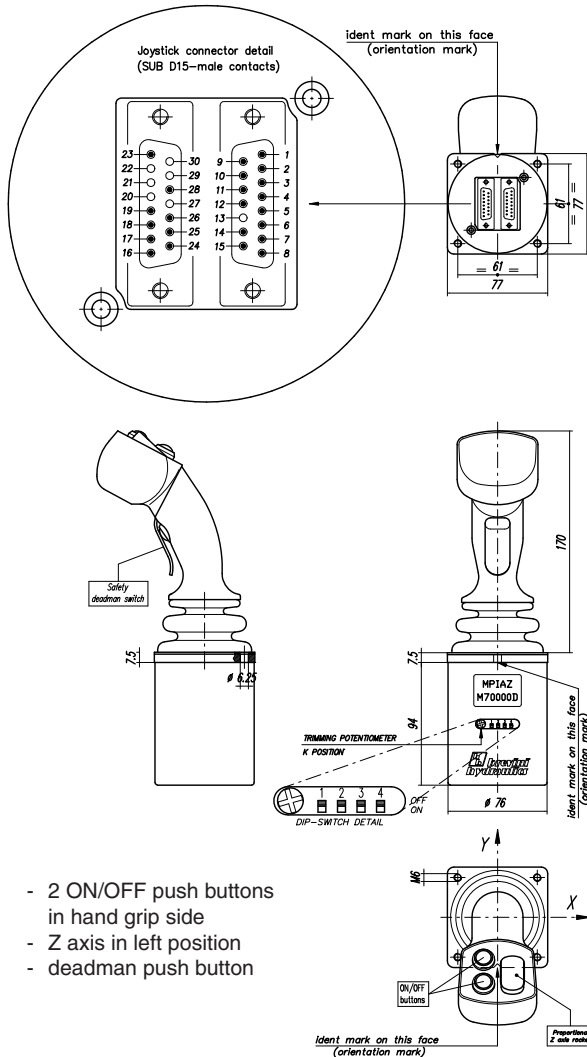

- 2 ON/OFF push buttons in hand grip side
- Z axis in left position
- deadman push button

- |   |   |
|---|---|
| 1 = U-  | 16 = U-   |
| 2 = A / B common X axis                             | 17 = A / B common Z axis                            |
| 3 = A output control, X axis                        | 18 = A output control, Z axis                       |
| 4 = B output control, X axis                        | 19 = B output control, Z axis                       |
| 5 = B output control, Y axis                        | 20 = ( free )                                       |
| 6 = A output control, Y axis                        | 21 = ( free )                                       |
| 7 = A / B common Y axis                             | 22 = ( free )                                       |
| 8 = U+  | 23 = U+   |
| 9 = "A" port, directional output (max. load 30 mA)  | 24 = "A" port, directional output (max. load 30 mA) |
| 10 = "B" port, directional output (max. load 30 mA) | 25 = "B" port, directional output (max. load 30 mA) |
| 11 = Safety switch on                               | 26 = switch on                                      |
| 12 = Common safety switch                           | 27 = ( free )                                       |
| 13 = ( free )                                       | 28 = switch on                                      |
| 14 = "B" port, directional output (max. load 30 mA) | 29 = ( free )                                       |
| 15 = "A" port, directional output (max. load 30 mA) | 30 = ( free )                                       |

### JMPIAZM7000LD (12V) JMPIAZM7020LD (24V)

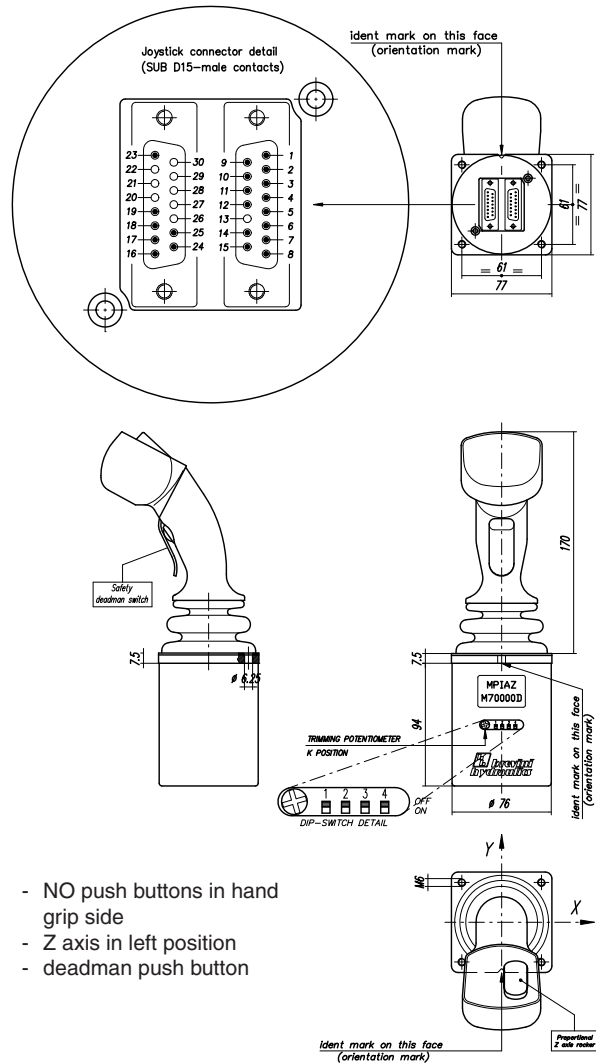

- NO push buttons in hand grip side
- Z axis in left position
- deadman push button

- |   |   |
|---|---|
| 1 = U-  | 15 = "A" port, directional output (max. load 30 mA) |
| 2 = A / B common X axis                             | 16 = U-   |
| 3 = A output control, X axis                        | 17 = A / B common Z axis                            |
| 4 = B output control, X axis                        | 18 = A output control, Z axis                       |
| 5 = B output control, Y axis                        | 19 = B output control, Z axis                       |
| 6 = A output control, Y axis                        | 20 = ( free )                                       |
| 7 = A / B common Y axis                             | 21 = ( free )                                       |
| 8 = U+  | 22 = ( free )                                       |
| 9 = "A" port, directional output (max. load 30 mA)  | 23 = U+   |
| 10 = "B" port, directional output (max. load 30 mA) | 24 = "A" port, directional output (max. load 30 mA) |
| 11 = Safety deadman switch on                       | 25 = "B" port, directional output (max. load 30 mA) |
| 12 = Common safety deadman switch                   | 26 = ( free )                                       |
| 13 = ( free )                                       | 27 = ( free )                                       |
| 14 = "B" port, directional output (max. load 30 mA) | 28 = ( free )                                       |
|   | 29 = ( free )                                       |
|   | 30 = ( free )                                       |

## Electrical system

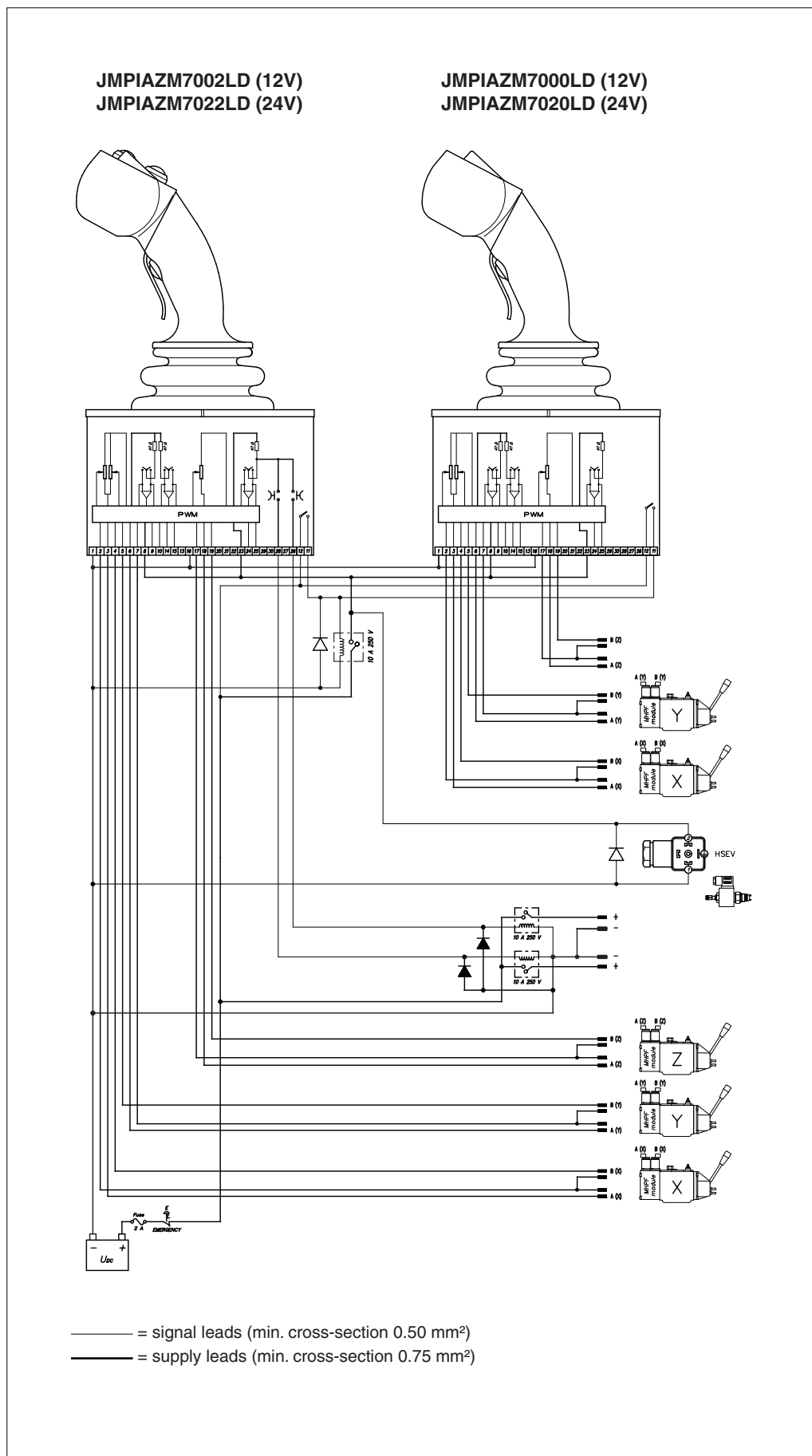

JMPID joystick is a strong and compact device, whose ergonomic shape is handily organised.

The person present system switch and many other remote control functions can be implemented and operated conveniently. It is developed to meet mobile machinery market requirements, where it is increasingly important to handle the power transmission supply with integrated remote control.

JMPID is simple to fit and replace and is made up of a standard module with two proportional axes and a hand grip that can house several combinations of other ON/OFF outputs.

This joystick allows all the electronic features of ramp generator function, electronic flow adjustment, and dead band compensation (only for proportional axes).

K handle  
(no switch)

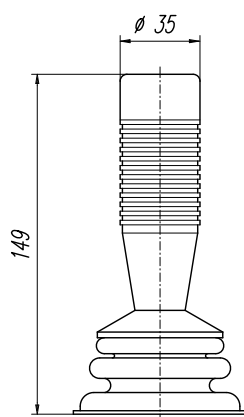

JMPID0M700530 (12V)  
JMPID0M700535 (24V)

H handle  
(rocker switch)

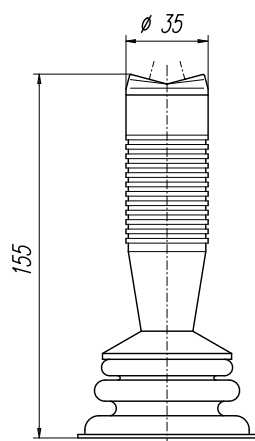

JMPID0M700531 (12V)  
JMPID0M700536 (24V)

L handle  
(deadman switch)

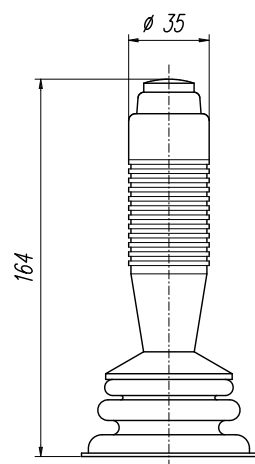

JMPID0M700533 (12V)  
JMPID0M700538 (24V)

### Dimensions and electrical details

### “K” Handle (no switch)

**JMPID0M700530 (12V)**

**JMPID0M700535 (24V)**

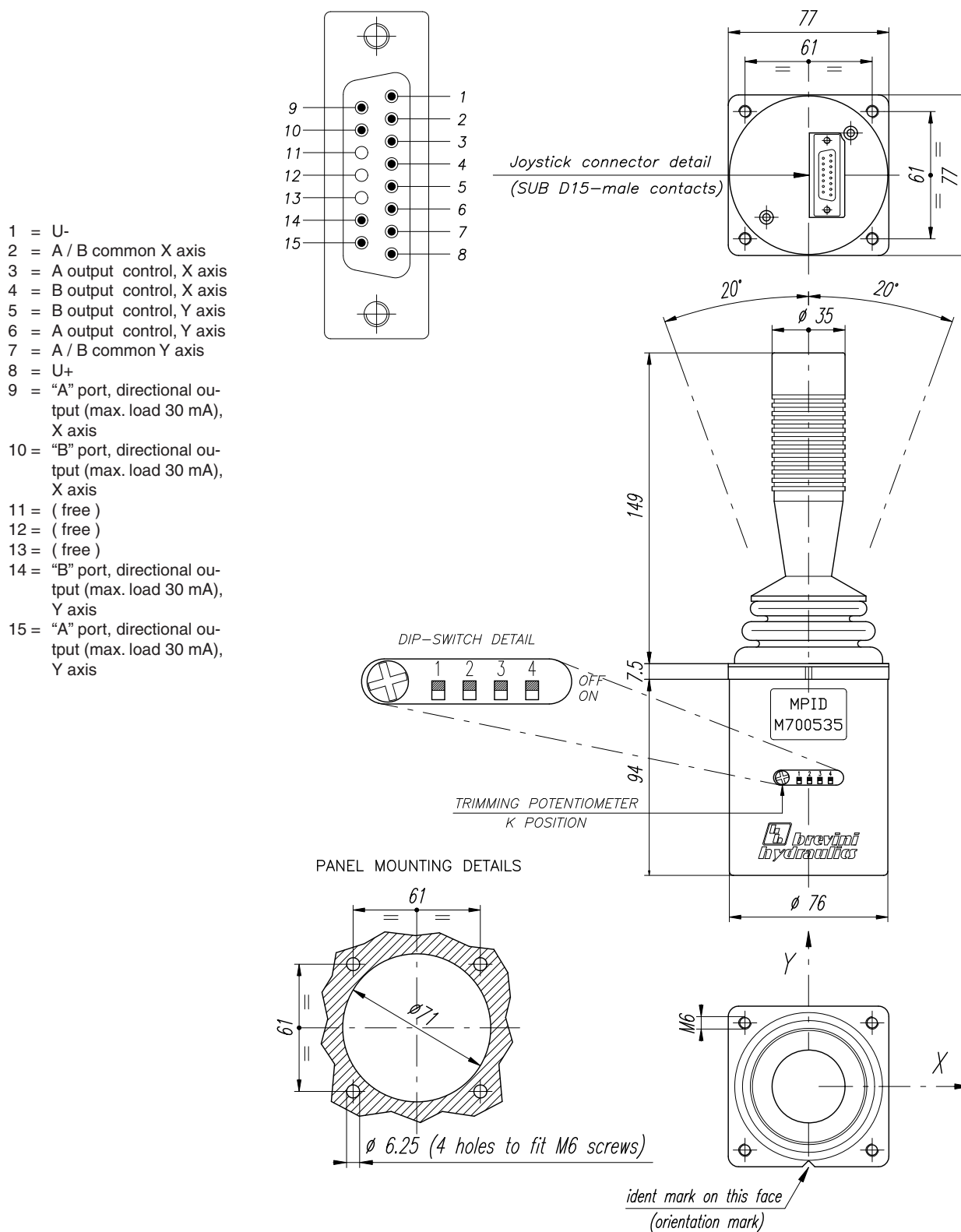

## Electrical system

“K” Handle (no switch)  
 JMPID0M700530 (12V)  
 JMPID0M700535 (24V)

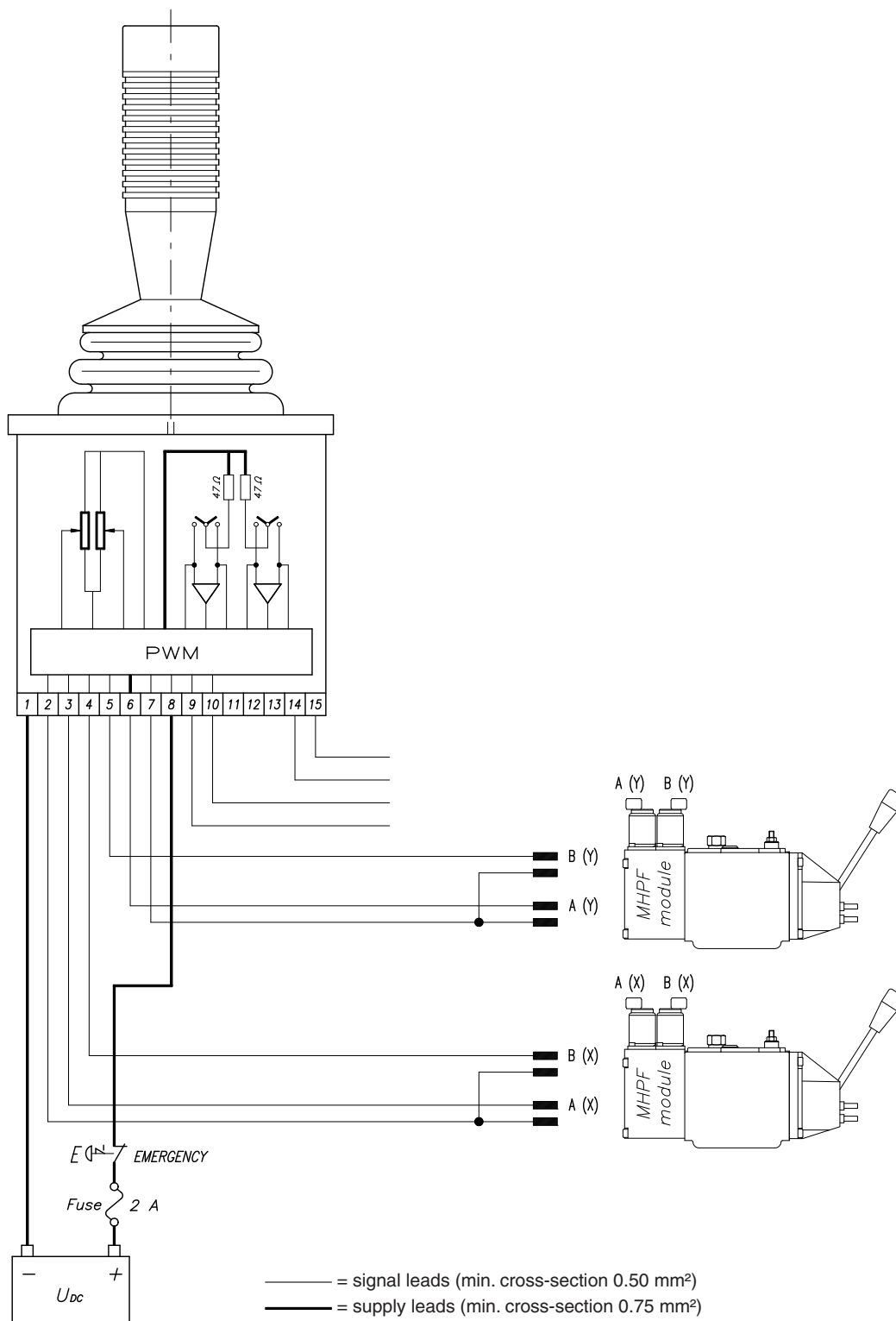

## Dimensions and electrical details

### "H" Handle (rocker switch)

JMPID0M700531 (12V)

JMPID0M700536 (24V)

- 1 = U-
- 2 = A / B common X axis
- 3 = A output control, X axis
- 4 = B output control, X axis
- 5 = B output control, Y axis
- 6 = A output control, Y axis
- 7 = A / B common Y axis
- 8 = U+
- 9 = "A" port, directional output (max. load 30 mA), X axis
- 10 = "B" port, directional output (max. load 30 mA), X axis
- 11 = Switch on (max. load = 30 mA)
- 12 = Common terminal switch on/off/on
- 13 = Switch on (max. load = 30 mA)
- 14 = "B" port, directional output (max. load 30 mA), Y axis
- 15 = "A" port, directional output (max. load 30 mA), Y axis

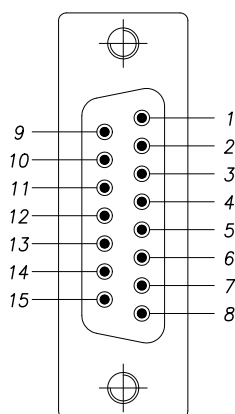

Joystick connector detail  
(SUB D15-male contacts)

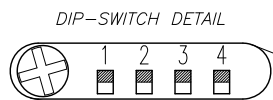
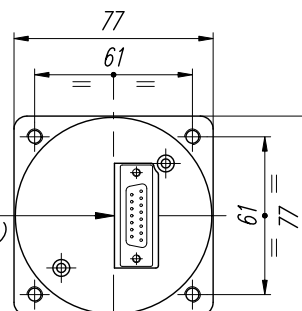

TRIMMING POTENTIOMETER  
K POSITION

### PANEL MOUNTING DETAILS

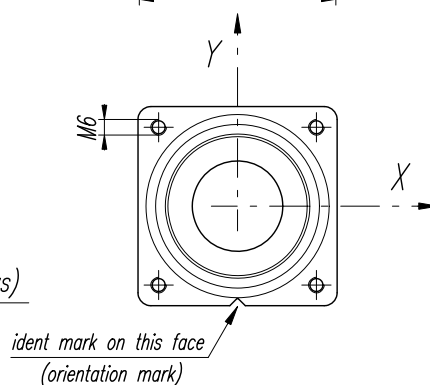
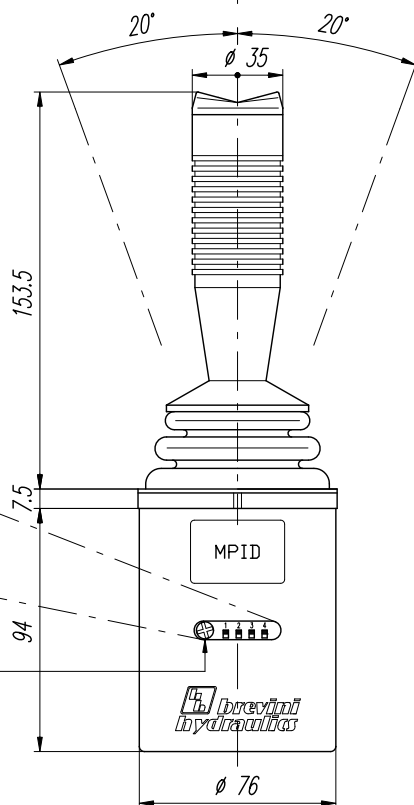
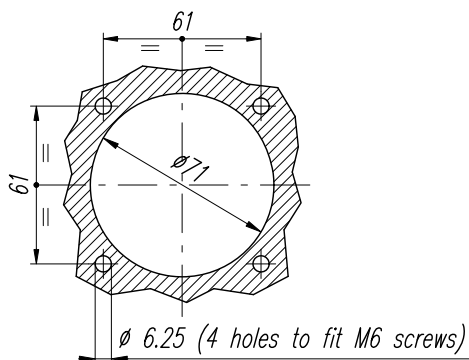

## Electrical system

“H” Handle (rocker switch)  
 JMPID0M700531 (12V)  
 JMPID0M700536 (24V)

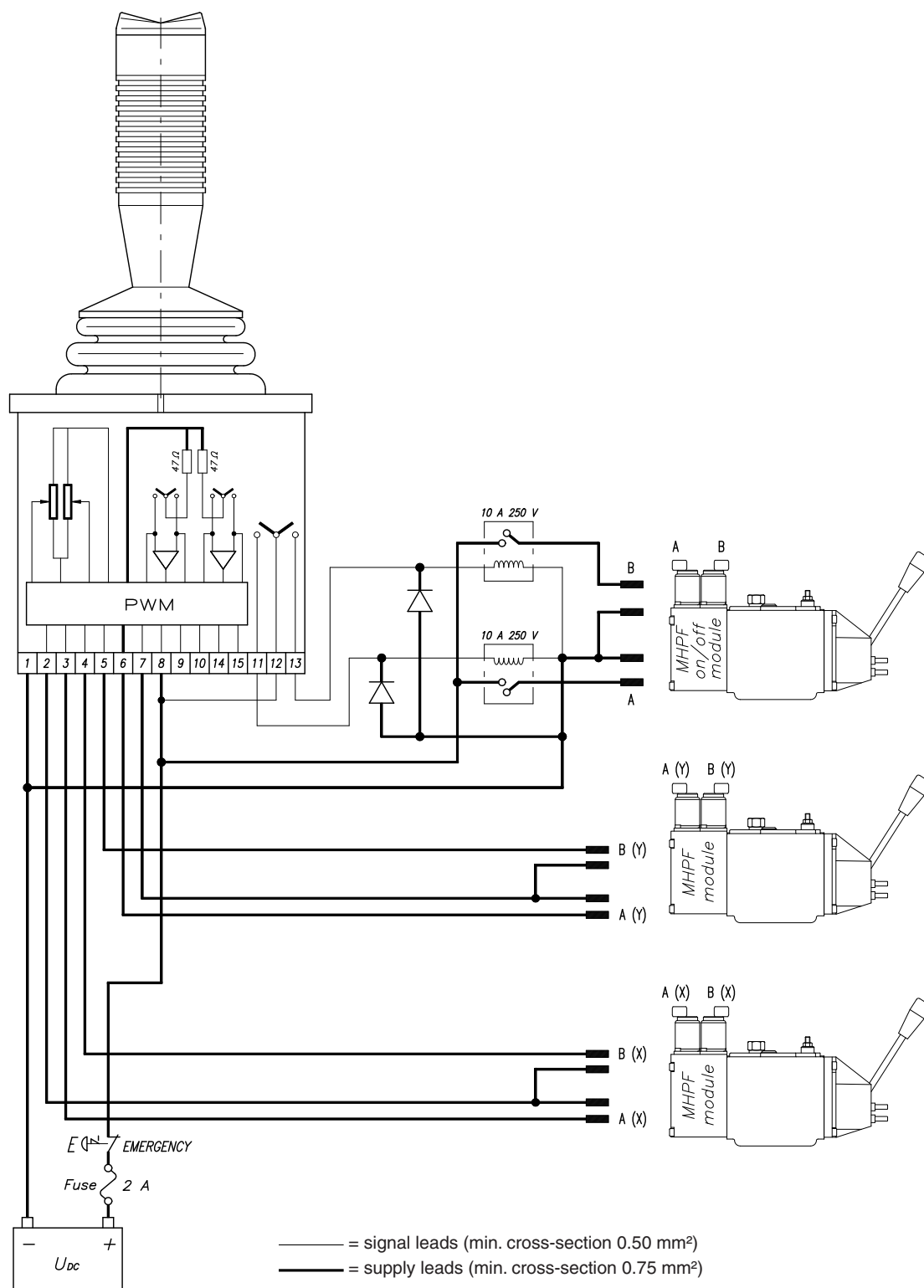

## Dimensions and electrical details

### "L" Handle (deadman switch)

JMPID0M700533 (12V)

JMPID0M700538 (24V)

- 1 = U-
- 2 = A / B common X axis
- 3 = A output control, X axis
- 4 = B output control, X axis
- 5 = B output control, Y axis
- 6 = A output control, Y axis
- 7 = A / B common Y axis
- 8 = U+
- 9 = "A" port, directional output (max. load 30 mA), X axis
- 10 = "B" port, directional output (max. load 30 mA), X axis
- 11 = Switch on (max. load = 30 mA)
- 12 = Common terminal switch on/off
- 13 = ( free )
- 14 = "B" port, directional output (max. load 30 mA), Y axis
- 15 = "A" port, directional output (max. load 30 mA), Y axis

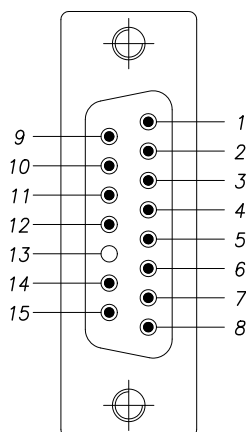

Joystick connector detail  
(SUB D15-male contacts)

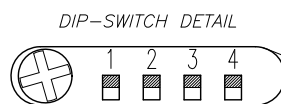
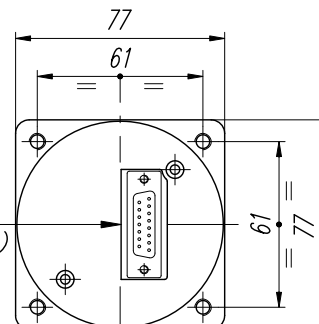

TRIMMING POTENTIOMETER  
K POSITION

### PANEL MOUNTING DETAILS

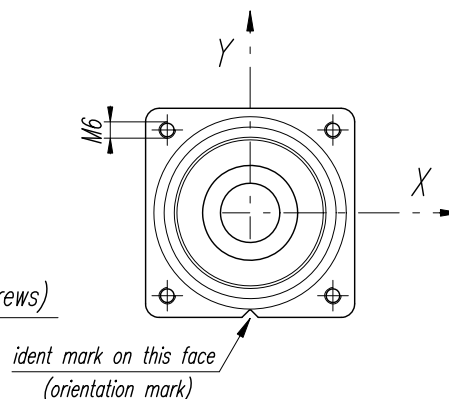
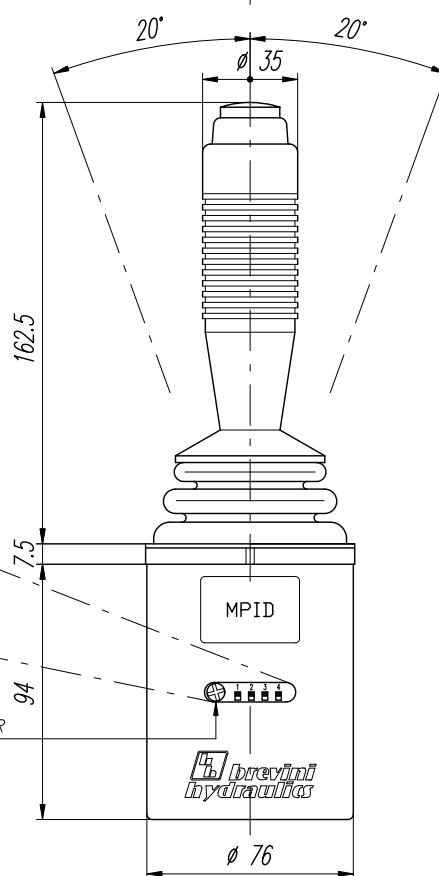
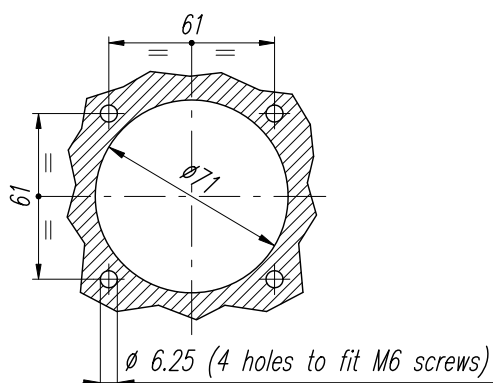

## Electrical system

“L” Handle (person present system switch)  
JMPID0M700533 (12V)  
JMPID0M700538 (24V)

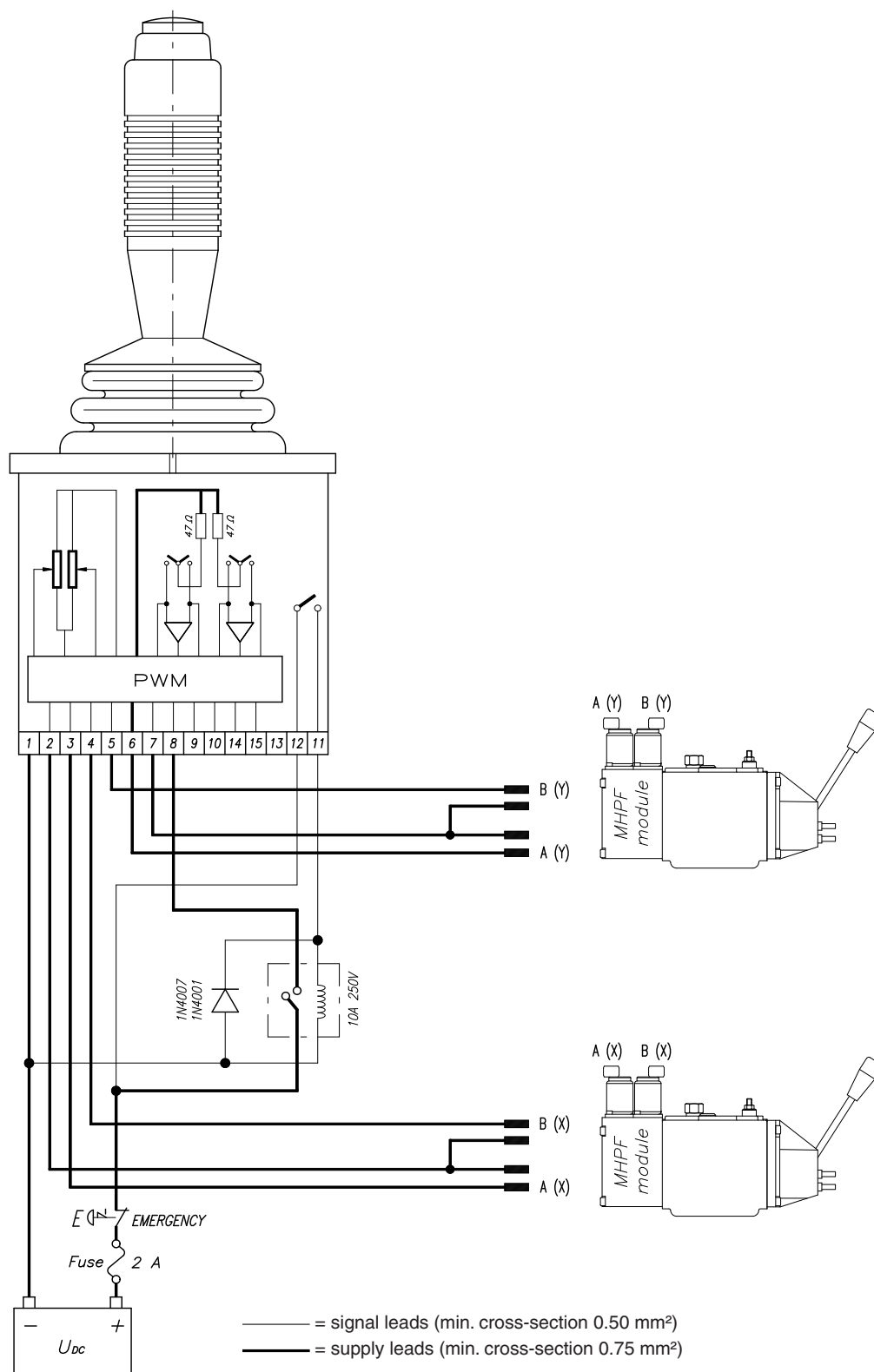



Factory:

Via Natta, 1

42100 Reggio Emilia - Italy

Tel. +39 0522 5058

Fax +39 0522 505856

[www.aron.it](http://www.aron.it)



Via Natta, 1

42100 Reggio Emilia - Italy

Tel. +39 0522 748700

Fax +39 0522 748750

[www.brevinifluidpower.com](http://www.brevinifluidpower.com)

[sales.ind@brevinifluidpower.com](mailto:sales.ind@brevinifluidpower.com)



ISO 9001:2000 - Cert. n° 0134

---