

## OUTLET MODULE UNITS

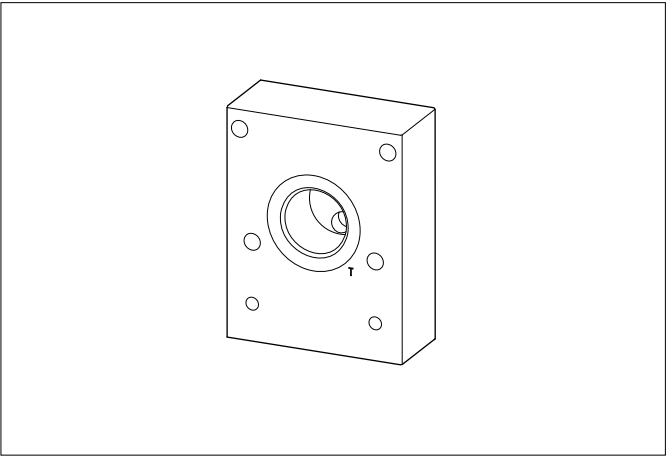

**Outlet module units**  
Outlet module with T port G1/2" threaded. Cast iron zinc plated body.

### HYDRAULIC SYMBOL

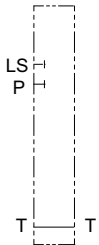

### ORDERING CODE

|            |                                |
|------------|--------------------------------|
| <b>FUH</b> | Outlet module unit             |
| <b>3</b>   | Size                           |
| <b>5</b>   | Port size:<br><b>5</b> = G3/4" |
| <b>00</b>  | <b>00</b> = No variants        |
| <b>1</b>   | Serial No.                     |

### FEATURES

|  |   |
|--|---|
| Max. operating pressure                                    | 300 bar   |
| Max. Flow  | 80 l/min  |
| Hydraulic fluids   | Mineral oils DIN 51524                              |
| Fluid viscosity  | 10 ÷ 500 mm <sup>2</sup> /s                         |
| Fluid temperature  | -25° ÷ 75° C  |
| Ambient temperature  | -25°C ÷ 60°C  |
| Max. contamination level<br>(filter $\beta_{25} \geq 75$ ) | ISO 4406:1999: class 21/19/16<br>NAS 1638: class 10 |
| Weight   | 1.2 kg  |

### OVERALL DIMENSIONS

