

RI25

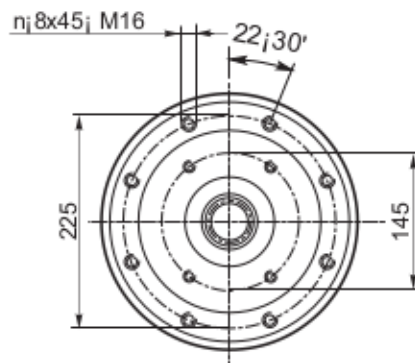

Carico max. / Maximum load
Max. Belastung / Charge max.
Carga máxima / Carga máxima

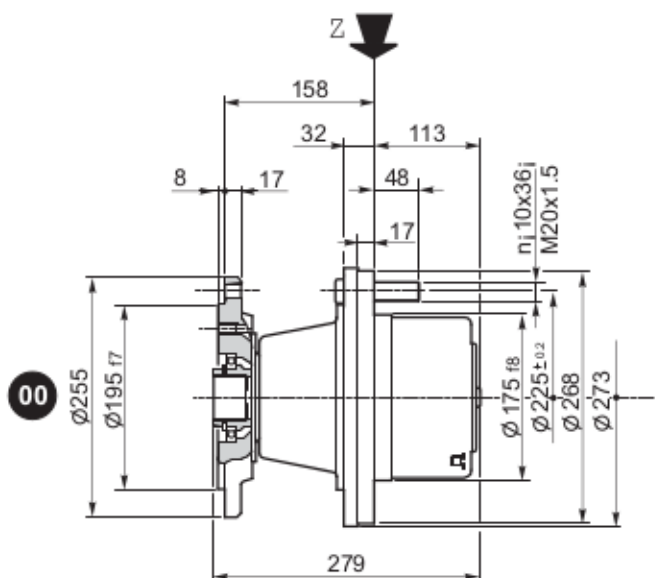
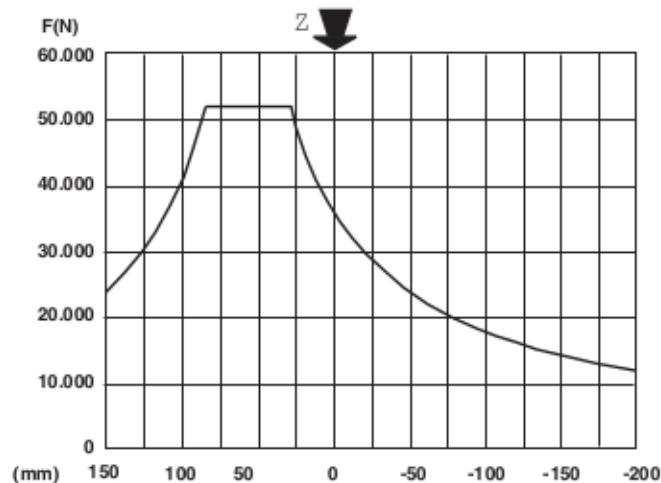

$$n_2 \cdot h = 300.000$$

Questo diagramma considera solo carichi radiali
This diagram shows radial loads only
Dieses Diagramm berücksichtigt nur Radiallasten
Ce diagramme considère seulement des charges radiales
En este diagrama se consideran sólo cargas radiales
Este diagrama considera somente cargas radiais



DIN 74361 B/C

Cod./Code/Kode 600M200BC10
Code/Cód./Cód.

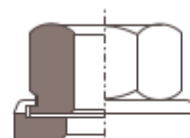

DIN 74361 H

Cod./Code/Kode 600M200H010
Code/Cód./Cód.

A richiesta; specificare il codice
On request; pls. specify the code
Auf Anfrage; bitte Kenn-Nr. angeben
Sur demande; spécifier le code
Opcional; indicar el código
Em caso de pedido, especificar o código

Dati tecnici / Specifications / Technische Daten Caractéristiques techniques / Datos técnicos / Características técnicas

Tipo / Type / Typ / Type / Tipo / Tipo	T _{2 max.} [Nm]	T _{1 max.} [Nm]	F _{max.} [N]	n _{1 max.} [rpm]	i = (*) non disinseribile / no disengage / nicht ausschaltbar / non débrabotables / sin embrague / não desengatáveis	Kg.	It.
RI25	4.500	270	51.000	4.000	11,4 - 12,73 - 14,21 - 19 - 21,69 - 25,45 - 31,26*	50	0,8

RF25

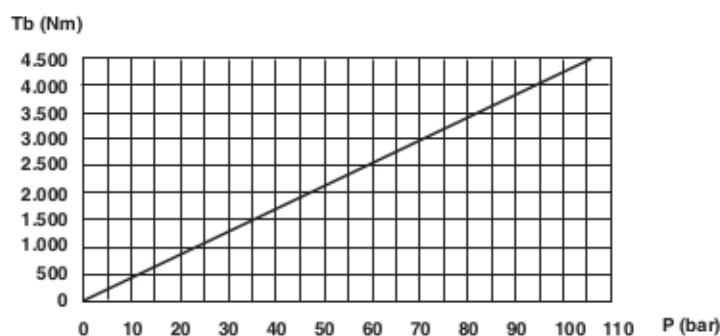
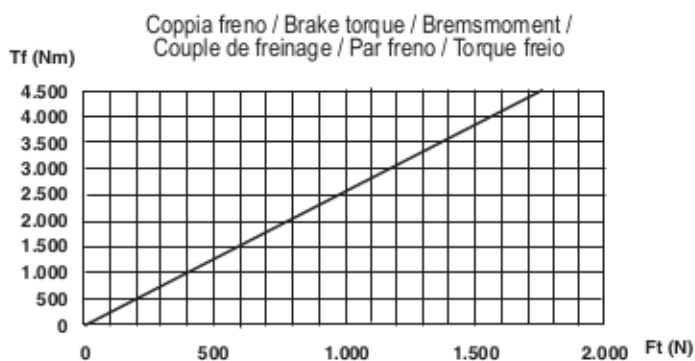
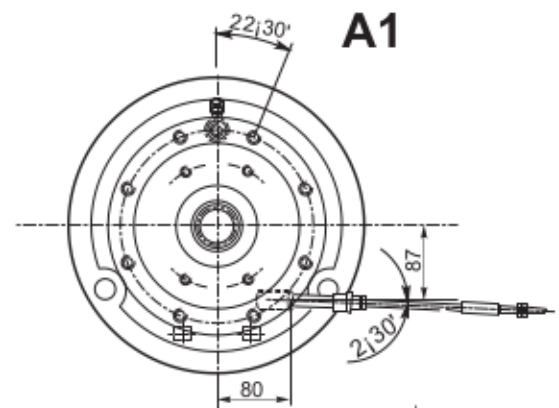
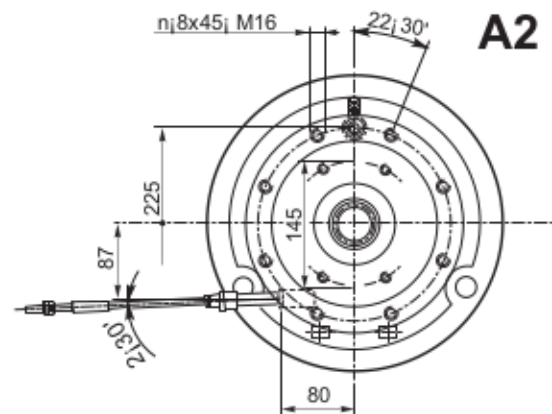
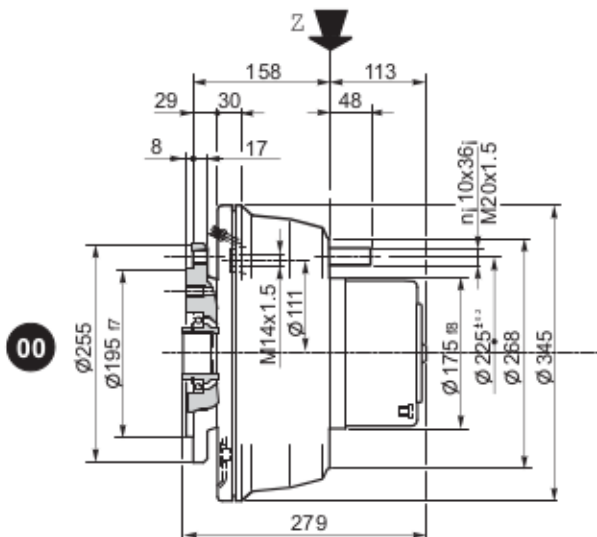

DIN 74361 H

Cod./Code/Kode 600M200H010
Code/Cód./Cód.





DIN 74361 B/C

Cod./Code/Kode 600M200BC10
Code/Cód./Cód.

A richiesta; specificare il codice
On request; pls. specify the code
Auf Anfrage; bitte Kenn-Nr. angeben
Sur demande; spécifier le code

Opcional; indicar el código
Em caso de pedido, especificar o código

Dati tecnici / Specifications / Technische Daten
Caractéristiques techniques / Datos técnicos / Características técnicas

Tipo / Type / Typ / Type / Tipo / Tipo	T _{2 max.} [Nm]	T _{1 max.} [Nm]	F _{max.} [N]	n _{1 max.} [rpm]	i = (* non disinseribile / no disengage / nicht ausschaltbar / non décrabotables / sin embrague / não desengatáveis	 Kg.	 lt.
RF25	4.500	270	51.000	4.000	11,4 - 12,73 - 14,21 - 19 - 21,69 - 25,45 - 31,26*	50	0,8

Freni a tamburo / Drum brake / Trommelbremse / Freins à tambour / Frenos de tambor / Freio a tambor

Ft [N]	P_{max} [bar]	V [cm³]	Tb max [Nm]
1.750	108	4.5	4.500